

Commonwealth of Kentucky

Energy and Environment Cabinet

Division of Water

CONSTRUCTION PERMIT APPLICATION for CLEAN WATER COLLECTION SYSTEM

See the INSTRUCTIONS for more information about selected portions of this application.

Questions on completing this application? Contact the Water Infrastructure Branch at 502/564-3410 or visit our website at <http://water.ky.gov> for more information.

I. CONSTRUCTION PROJECT INFORMATION

Project Name: Southwest One Industrial Development - Water & Sewer Improvements - Phase 1 Sewer Ext.

Name of WWTP which will treat sewage from this project: Benton STP

KPDES Number of the WWTP: KY0 KY0021172 WWTP County: Marshall

Project County: Marshall

Project Latitude/Longitude (DMS) 36^49'06.98" N / 88^21'58.5" W

Estimated construction cost of this project: \$ 150,000.00

Is this a funded project:

CWSRF SPAP Other: _____

If the answer is yes, provide applicable funding checklist.

II. APPLICANT MAILING ADDRESS

Applicant (Entity paying for construction): Marshall County Fiscal Court

Street Address: 1101 Main Street

City, State, Zip: Benton, KY 42025

Phone 270-527-4750 Fax _____ E-mail kevin.neal@marshallcountyky.gov

Will ownership be transferred? Yes, future owner will be: City of Benton, KY No

III. DESIGN CONSIDERATIONS

A. PLANS AND SPECIFICATIONS COMPLIANCE REQUIREMENTS:

Design plans and specifications shall comply with **401 KAR 5:005** and "**Recommended Standards for Wastewater Facilities**" ("**Ten States' Standards**"). If engineering practices, other than those contained in "Ten States' Standards", were used in the design, indicate the source and the corresponding portion of the design. [**401 KAR 5:005 Section 7**]

For plans submitted to this office, one set of plans must have an original signed and dated P.E. stamp. The additional plan sets must have either an original signature and dated stamp, or a legible facsimile thereof. SRF funded projects shall include at least 1 printed copy of specifications.

Plan and specification submittals shall meet one of the following options:

At least **one** paper printed set of detailed plans (no larger than 24" X 36") **and** a PDF copy of plans and specifications on CD/DVD. The PDF copy shall contain a stamp, signature, and date. The plans on the CD/DVD shall be in a folder called "Engineering Plans" and the specifications manual shall be in a folder called "Specifications".

At least **2** paper printed sets of detailed plans (one shall be no larger than 24" X 36" and the other set shall be 11" X 17") and **one** paper copy of the specifications manual.

B. DESIGN ENGINEER, if the sewer lines will become part of a sewer system served by a regional facility. **[Section 6]**

P.E.'s Name/Firm: Charles D. McCann II, PE / Rivercrest Engineering, Inc.

Street Address: 7020 US Hwy 68, West

City, State, Zip: Paducah, KY 42003 Phone: (618)521-5421 E-mail cmccann@rivercresteng.com

C. CONFORMITY TO PLANS AND SPECIFICATIONS. Provide name of person who will inspect and certify that the constructed facility conforms to the approved plans and specifications. If the sewer lines will become part of a sewer system served by a regional facility, this person must be a professional engineer (P.E.). **[Section 3]**

Name/Firm: Charles D. McCann II, PE / Rivercrest Engineering, Inc.

Street Address: 7020 US Hwy 68, West

City, State, Zip: Paducah, KY 42003 Phone: (618)521-5421 E-mail cmccann@rivercresteng.com

D. DESIGN CAPACITIES. The amount of average daily flow added by the sewer line extension is 1,000 gpd. The basis for the amount of additional flow is Marshall Co. Industrial Development Authority - Flows included as part of LS project.

E. OTHER INFORMATION TO BE SUBMITTED WITH APPLICATION. Place a **check (x)** by the items that are included in this application or an **N/A** if the item is not applicable to the project.

1. A copy of a USGS 7½ minute topographic map with the locations of the proposed project shown. **[Section 3]**

2. If modifying, replacing or abandoning an existing facility, a closure plan indicating how the new facility will be constructed without a by-pass to a stream and the procedures that will be used for abandoning the existing facility. **[Section 3]**

3. If the project includes a pump station, provide the pump performance curve, design calculations, and detailed wet well drawing with elevations. **[Section 8]**

4. If the project includes gravity sewer lines or force mains, a plan view and a profile view of each. **[Section 6]**

5. A model of the hydraulic analysis if the project consists of, or is connected to a network of pumps. **[Section 8].**

6. A brief description of the project, including what is being constructed, who will be served by this project, the flow rate, and flow rate calculations. **[Section 8]**

7. A signed letter from the owner of the proposed sewer line stating that the owner will accept responsibility for the operation and maintenance of the sewer line when it is constructed. **[Section 8]**

8. A signed letters from both the owner of the receiving sewer system and the WWTP stating that they approve the connection and accept responsibility for the additional flow. **[Section 8]**

9. A written statement that the portion of the sewer system used by the connection has adequate capacity to transport the current and anticipated peak flow to the WWTP and that the portion of the sewer system used by the connection is not subject to excessive infiltration or excessive inflow. **[Section 8]**

10. A completed sewer sanctions exemption request form has to be submitted, if the receiving WWTP for this

project is on sewer sanction. (Required only when additional flow is added). [Section 9]

IV. Environmental Benefits

Check all the items that apply. Identify the environmental benefit(s) of the project.

- Construction of a new sewer lines to service previously non-sewer customers. Number of connections to these customers. _____
- Upgrading of existing sewer lines. Reduction of I&I, CSO, or SSO problems.
- Elimination of package plant. KPDES Number of the WWTP: KY0 _____.
- Elimination of failing septic tanks. Number removed _____.
- Elimination of straight pipe. Number removed _____.
- Other: Provide a brief description in the space below.

V. Fees

Fees. Check or money order must be made payable to "Kentucky State Treasurer" for the total amount. **Fees do not apply** for a municipality, sanitation district, or other publicly owned facility. [Section 5] If claiming Non-Profit status, provide proof.

Sewer Collection Project Category: POTW Total Amount: \$ 0.00

VI. CERTIFICATION

I, the applicant, certify under penalty of law that this document and all attachments were prepared under my direction or supervision. The information submitted is, to the best of my knowledge and belief, true, accurate, and complete. I am aware that there are significant penalties for submitting false information, including the possibility of fine or imprisonment or both for known violations.

[Section 2]

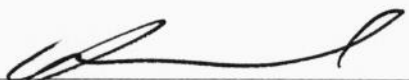
| | |
|--|---|
| Applicant's Name and Official Title (Type or Print) Kevin Neal - Judge Executive | Phone Number (Include area code) 270-527-4750 |
| Signature  | Date 5/21/2019 |

INSTRUCTIONS--Form S-1a

Listed below are explanations of selected questions on Form S-1a. If you need further information about any item, contact the **Water Infrastructure Branch, Engineering Section, at 502/564-3410**. Send completed application with applicable enclosures and applicable permit fee to the Division of Water, Water Infrastructure Branch, 200 Fair Oaks Lane 4th Floor, Frankfort, KY 40601. The complete requirements for construction permits are in Kentucky's administrative regulation **401 KAR 5:005**; definitions for terms are in **401 KAR Chap 10**. Specific cites to **401 KAR 5:005** are given for selected items.

I. CONSTRUCTION PROJECT INFORMATION

- Project Name Describe the facility served by the proposed sewer line extension. For example, Knoll Subdivision, Jones' Lane, Smith's Market.
- KPDES Number This is available from the owner of the WWTP which will receive the waste.
- Funding Sources List agencies providing funds to pay construction costs. For example, Kentucky Infrastructure Authority CWSRF Loan, State grants, Federal Grants, local funds, and private funds.
- SRF Checklist Information on the SRF checklist can be found at http://dep.ky.gov/formslibrary/Documents/EPA_KIA_Checklist.pdf

II. APPLICANT INFORMATION

- Name Name of the entity paying for construction, not the funding agency (**KIA, Rural Development Administration (former FmHA), etc.**) or name of the contractor who is constructing the sewer lines, pump station, or force mains for another entity.
- Address Location where correspondence should be sent, not the address of the project that the sewer line extension will serve.
- Ownership Transfer: If the sewer line extension will be transferred to a municipality or other regional facility, give name of entity that will be the new owner. Upon transfer, the NEW owner must submit to the Division of Water a "Change in Ownership Certification for Sewer Line Extensions," available from the Water Infrastructure Branch. The applicant will remain the responsible party until the transfer is completed.

III. DESIGN CONSIDERATIONS

- A. Plans and Specifications.** Any deviations from "Ten States' Standards," 2004 edition, must be submitted to the Division of Water in writing with the basis for the deviation, supported by current engineering practice. Other alternative measures may be approved if the applicant submits the basis for the alternatives, and the alternatives may include special maintenance procedures or sufficient treatment. Seals and Signature for electronic shall be in compliance with 201 KAR 18:104
- B. Design Engineer.** If the proposed sewer line extension will become part of a sewer system served by a regional facility, the plans and specifications must be prepared, stamped, signed, and dated by a professional engineer, licensed to practice in Kentucky. Give the name, firm, and address of the design engineer.
- E. Other Information.**
USGS 7½ minute topographic maps are available from the Economic Development Cabinet, Map Sales Office, 133 Holmes Street, Frankfort, KY 40601, phone **502/564-4715**.
9 & 10. An example of the necessary demonstrations would be letters from the owner of the sewer system (7) and the WWTP (8) stating that each had sufficient capacity to transport the current and anticipated flow and that neither is subject to excessive infiltration or excessive inflow. Applicants may provide other demonstrations.

V. FEES

Construction Permit Fees are listed in **401 KAR 5:005**. The construction permit fee must be submitted with the completed permit application. The fee must be a check or money order, payable to the **Kentucky State Treasurer**, for the applicable amount as indicated below. Fees are not applicable if the **applicant** (entity paying for construction) is a publicly owned facility. Examples are DOT rest areas, school facilities, and regional airport authorities.

| | |
|---|---------------|
| Facility for Qualified Non-Profit Organization*: (Pump station or sewer line or force main) | \$ 50 |
| Small Facility: (Pump station or sewer line or force main less than 2,500 feet in length) | \$ 200 |
| Intermediate Facility: (Pump station or sewer line or force main 2,500 to 5,000 feet in length) | \$ 400 |
| Large facility: (Pump station or sewer line or force main more than 5,000 feet in length) | \$ 800 |

Enter the category (small, intermediate, or large) and the dollar amount submitted. When determining the fee category, **add** the total lengths of **all** pipe to be installed.

* To qualify for the \$50 fee, non-profit organizations must submit proof that they qualify for the reduction under Section 501(c)(3) of the Internal Revenue Code.

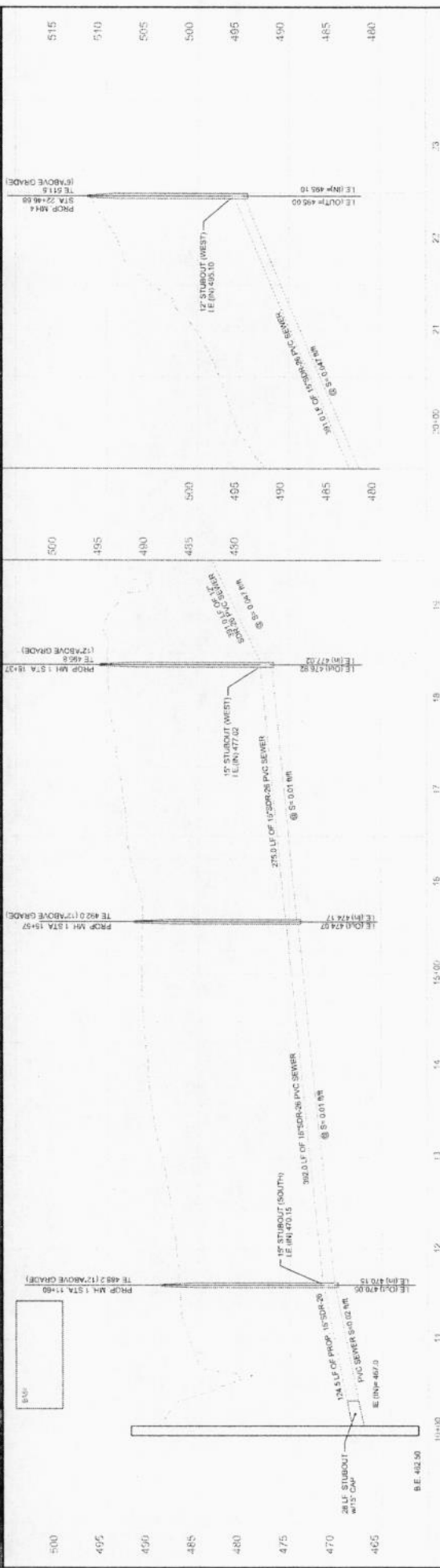
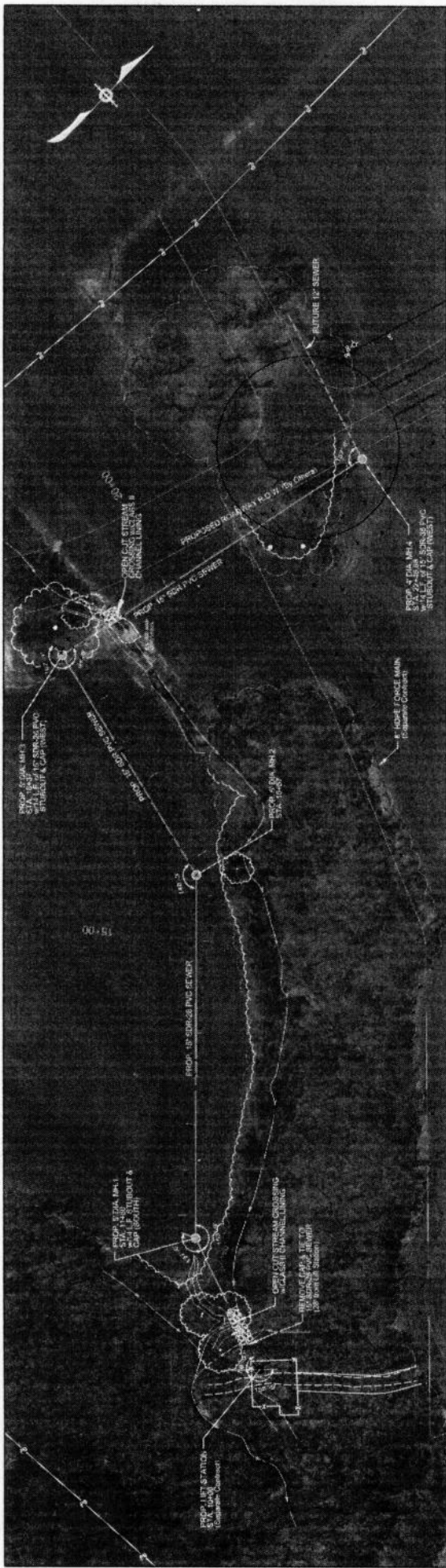

| | | | | | |
|------------|--|------------------|--|-------|----------|
| DATE | 11/1/20 | PROJECT NO. | 10009 | SCALE | AS SHOWN |
| BY | ELV | DESIGNED BY | CON | DATE | 11/1/20 |
| CHECKED BY | RFM | PROJECT ENGINEER | MARSHALL CO. INDUSTRIAL DEVELOPMENT AUTHORITY 93 CARROLL ROAD BENTON, KY 42025 | | |
| PROJECT | SOUTHWEST ONE SITE SANITARY SEWER EXPANSION (PHASE 1) | | | | |
| DATE | 11/1/20 | | | | |
| PROJECT | SOUTHWEST ONE SITE SANITARY SEWER EXPANSION (PHASE 1) | | | | |
| ENGINEER | Rivercrest Engineering, Inc. 7000 U.S. HWY. 68 N PADUCAH, KY 40301 | | | | |